

IN-STOCK CATALOG

September 2022



INNOVATE. AUTOMATE. CREATE. DISRUPT.
Accelerate your Competitive Advantage...



Zeeland, Michigan

sales@industrialcontrol.com • 800.878.6722 • 616.748.8200 • www.industrialcontrol.com



S8 SERIES SENSORS

Part Number Model Number	Description	Range	Connection
<u>950801180</u> S8-PR-3-B01-PP	Polarized Retroreflective, PNP	5 m	M12 Pigtail
<u>950801250</u> S8-PR-3-C01-PP	LED Diffuse, PNP	500 mm	M12 Pigtail
<u>950801220</u> S8-PR-3-M01-PP	LED Background Suppression, PNP	300 mm	M12 Pigtail
<u>950801100</u> S8-PH-3-M01-PP	Laser Background Suppression, PNP	200 mm	M12 Pigtail

S5N SERIES SENSORS

Part Number Model Number	Description	Range	Connection
<u>952001041</u> S5N-PR-5-B01-PP	Radial, Polarized Retroreflective, PNP	4 m	M12 4 Pin
<u>952001021</u> S5N-PA-5-B01-PP	Axial, Polarized Retroreflective, PNP	4 m	M12 4 Pin

S65 SERIES SENSORS

Part Number Model Number	Description	Range	Connection
<u>956251161</u> S65-PA-5-M13-00	Time of Flight, LED IR, Background Suppression, PNP/NPN, LO/DO	5 m	M12 5 Pin

MOUNTING BRACKETS

Part Number	Model Number	Description
<u>95ACC1470</u>	ST-5072	S8 Right Angle Vertical Mount
<u>95ACC7860</u>	ST-S8-FRM	S8 Right Angle Horizontal Mount
<u>ST 12-C</u>	ST 12-C	M12 Right Angle Mount
<u>ST 18-C</u>	ST 12-C	M18 Right Angle Mount

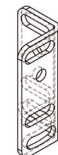

ST-5072



ST-S8-FRM



ST 12-C



ST 18-C

M8 PROX SENSORS

Part Number/ Model Number	Description	Range	Connection
<u>AE6/AP-3F</u> <u>AE6/AN-3F</u>	Shielded, NO, PNP Shielded, NO, NPN	2 mm	M8, 3 Pin, QD
<u>AE6/AP-2F</u> <u>AE6/AN-2F</u>	Unshielded, NO, PNP Unshielded, NO, NPN	2.5 mm	M8, 3 Pin, QD

M12 PROX SENSORS

Part Number/ Model Number	Description	Range	Connection
<u>AM6/AP-3H</u> <u>AM6/AN-3H</u>	Shielded, NO, PNP Shielded, NO, NPN	4 mm	M12, 4 Pin, QD
<u>AM6/AP-4H</u> <u>AM6/AN-4H</u>	Unshielded, NO, PNP Unshielded, NO, NPN	8 mm	M12, 4 Pin, QD

M18 PROX SENSORS

Part Number/ Model Number	Description	Range	Connection
<u>AK6/AP-3H</u>	Shielded, NO, PNP	8 mm	M18, 4 Pin, QD
<u>AK6/AP-4H</u>	Unshielded, NO, PNP	12 mm	M18, 4 Pin, QD

REFLECTORS

Part Number	Model Number	Description
<u>95A151340</u>	R4	47 x 47 mm Square Reflector
<u>S940700075</u>	R5	∅ 75 mm Circular Reflector
<u>S940700048</u>	R2	∅ 48 mm Hexagonal Reflector
<u>S940000900</u>	RT-3970	200 x 3000 mm Self-Adhesive Reflective Tape



R4



R5

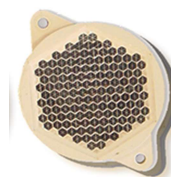

R2

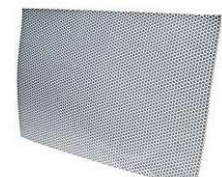

RT-3970

SG4 TYPE 4 SAFETY LIGHT CURTAINS

19 M operating distance, M12 X 4 Pin Emitter, and M12 X 8 pin Receiver

Part Number	Model Number	Description
<u>957901010</u>	SG4-14-030-00-E	300 mm Length, 14 mm Resolution
<u>957901020</u>	SG4-14-045-00-E	450 mm Length, 14 mm Resolution
<u>957901030</u>	SG4-14-060-00-E	600 mm Length, 14 mm Resolution
<u>957901040</u>	SG4-14-075-00-E	750 mm Length, 14 mm Resolution
<u>957901050</u>	SG4-14-090-00-E	900 mm Length, 14 mm Resolution
<u>957901060</u>	SG4-14-105-00-E	1050 mm Length, 14 mm Resolution
<u>957901070</u>	SG4-14-120-00-E	1200 mm Length, 14 mm Resolution
<u>957901090</u>	SG4-14-150-00-E	1500 mm Length, 14 mm Resolution
<u>957901110</u>	SG4-14-180-00-E	1800 mm Length, 14 mm Resolution
<u>957901120</u>	SG4-30-015-00-E	150 mm Length, 30 mm Resolution
<u>957901130</u>	SG4-30-030-00-E	300 mm Length, 30 mm Resolution
<u>957901140</u>	SG4-30-045-00-E	450 mm Length, 30 mm Resolution
<u>957901150</u>	SG4-30-060-00-E	600 mm Length, 30 mm Resolution
<u>957901160</u>	SG4-30-075-00-E	750 mm Length, 30 mm Resolution
<u>957901170</u>	SG4-30-090-00-E	900 mm Length, 30 mm Resolution
<u>957901180</u>	SG4-30-105-00-E	1050 mm Length, 30 mm Resolution
<u>957901190</u>	SG4-30-120-00-E	1200 mm Length, 30 mm Resolution
<u>957901210</u>	SG4-30-150-00-E	1500 mm Length, 30 mm Resolution
<u>957901220</u>	SG4-30-165-00-E	1650 mm Length, 30 mm Resolution

SG4 TYPE 4 SAFETY LIGHT CURTAIN



SL4 SLIM TYPE 4 SAFETY LIGHT CURTAIN
6 M operating distance, M12 X 5 Pin Emitter, and Receiver
SL4 SLIM TYPE 4 LIGHT CURTAIN

Part Number	Model Number	Description
957910000	SL4-14-0150-E	150 mm Length, 14 mm Resolution
957910030	SL4-14-0300-E	300 mm Length, 14 mm Resolution
957910080	SL4-14-0450-E	450 mm Length, 14 mm Resolution
957910130	SL4-14-0600-E	600 mm Length, 14 mm Resolution
957910180	SL4-14-0750-E	750 mm Length, 14 mm Resolution
957910230	SL4-14-0900-E	900 mm Length, 14 mm Resolution
957910340	SL4-24-0150-E	150 mm Length, 24 mm Resolution
957910370	SL4-24-0300-E	300 mm Length, 24 mm Resolution
957910420	SL4-24-0450-E	450 mm Length, 24 mm Resolution
957910470	SL4-24-0600-E	600 mm Length, 24 mm Resolution
957910520	SL4-24-0750-E	600 mm Length, 24 mm Resolution
957910570	SL4-24-0900-E	900 mm Length, 24 mm Resolution
957910620	SL4-24-1050-E	1050 mm Length, 24 mm Resolution
957910670	SL4-24-1200-E	1200 mm Length, 24 mm Resolution
957910340	SL4-24-1500-E	1500 mm Length, 24 mm Resolution

DATASENSING SAFETY RELAY

Part Number	Model Number	Description
95ACC6170	SE-SR2	Safety Relay Relay 3NO + 1NC, DIN-Rail 23 mm

CONTRINEX SAFETY RELAY

Part Number	Description
YRB-4EML-31S	Safety Relay, 3 NO and 1 NC Outputs LED indicator for channels 1, 2 and power supply 22.5 mm wide, DIN-Rail



SAFETY FLOOR SCANNERS

Part Number Model Number	Description	Connection
<u>SLS-M5-1708-E</u> 958001030	Master 5.5m, 70 Zone Sets	M12 4 Pin M12 8 Pin M12 8 Pin M12 17 Pin
<u>SLS-SA3-08</u> 958001080	Standalone 3m, 6 Zone Sets	M12 4 Pin M12 8 Pin
<u>SLS-SA5-08</u> 958001090	Standalone 5.5m, 6 Zone Sets	M12 4 Pin M12 8 Pin
<u>SLS-R5-E</u> 958001120	Slave 5.5m	M12 8 Pin M12 8 Pin

FLOOR SCANNER MOUNTING BRACKETS

Part Number	Model Number	Description
95ASE2920	SLS-BRACKET-A	SLS Complete Bracket
95ASE2940	SLS-BRACKET-C	SLS Head Protective Bracket



SLS-BRACKET-A

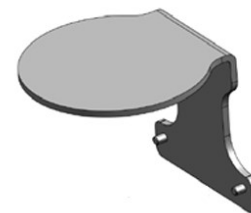

SLS-BRACKET-C

FIELD WIREABLES

Part Number Model Number	Description	Connection
<u>CL12/0B-00A</u>	Female M12 Field Wireable	M12 4 Pin
<u>CL08/0A-00A</u>	Female M8 Field Wireable	M8 3 Pin

M8 CABLES

Part Number Model Number	Description	Length	Connection
<u>CD08/0A-050A5</u>	M8 Cable, Straight, PUR, Single Ended	5 m	M8, 3 Pin
<u>CD08/0A-050C5</u>	M8 Cable, Right Angle, PUR, Single Ended	5 m	M8, 3 Pin

M12 CABLES

Part Number Model Number	Description	Length	Connection
<u>CD12M/0B-050A5</u>	M12 Cable, Straight, PUR, Single Ended	5 m	M12, 4 Pin
<u>CD12M/0B-050C5</u>	M12 Cable, Right Angle, PUR, Single Ended	5 m	M12, 4 Pin
<u>95ASE1150</u> CS-A1-02-U-15	M12 Cable, Straight, Single Ended	15 m	M12 4 Pin
<u>95A252950</u> CS-H1-03-B-001	SLIM Cascading Cable, Straight, Double Ended	10 cm	M12 5 Pin
<u>CD12M/0H-050A5</u>	M12 Cable, Straight, PUR, Single Ended	5 m	M12, 5 Pin
<u>95ASE1200</u> CS-A1-03-U-15	M12 Cable, Straight, Single Ended	15 m	M12 5 Pin
<u>95ASE1240</u> CS-A1-06-U10	M12 Cable, Straight, Single Ended	10 m	M12, 8 pin
<u>95ASE1250</u> CS-A1-06-U-15	M12 Cable, Straight, Single Ended	15 m	M12 8 Pin
<u>95ASE3030</u> CS-A1-15-U-15	M12 Cable, Straight, Single Ended	10 m	M12, 17 Pin





P2 Series Smart Camera

COMPACT SMART CAMERA

The P2x-Series is an industrial smart camera Powered by the 100+ inspection tools of IMPACT Machine Vision Software

CRISP IMAGES IN ANY CONDITION

P2x-Series Smart Cameras feature one of the most sophisticated optical designs Micro-video and C-Mount lenses

INTUITIVE VISUAL FEEDBACK

Stunning configurable 360° multi color visual feedback and configurable through IMPACT Software.

MAXIMUM INSPECTION ACCURACY AND REPEATABILITY

P2x-Series embedded 2-megapixel resolution imager enables high accuracy applications such as measurement or robot guidance. New set of color inspection tools to solve accurate color analysis.

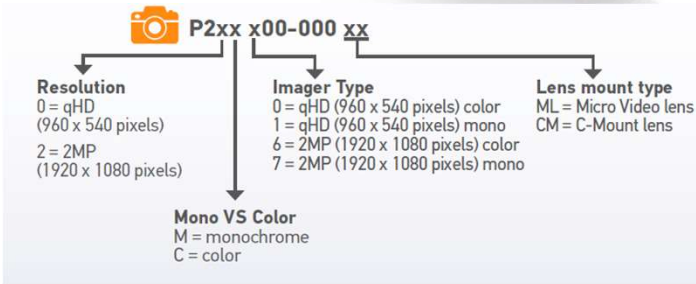

MX Series Camera Controller

SOLID STATE MULTI-CORE CONTROLLER

Proven multi-camera, high speed inspections with protected OS from virus or modification once setup.

MIX & MATCH CAMERAS/BARCODE READERS

Flexible design allows you run different cameras depending on your needs for less money.

BUILT IN HMI

Display all dumb camera and smart P2 cameras on the same screen with free CPM software...just plug in any monitor!

NO MORE SOFTWARE VERSIONS

Stop wondering if your laptop has the correct software on it. Program directly on the controller or offline at your desk with the free VPM emulator.



DataSensing Machine Vision Cameras

	Part Number	Description	Price Each	
P2 SERIES SMART CAMERAS	95A900008	LICENSE, ENHANCED, SMART CAMERA	\$643.07	
	937710024	P22C 600-000 ML, Color, 1920x1080, uses bayonet style lens	\$2,480.53	
	937710023	P22M 700-000 ML, Monochrome, 1920x1080, uses bayonet style lens	\$2,397.86	
	937710022	P20C 000-000 ML, Color, 950x540, uses bayonet style lens	\$1,396.44	
	937710021	P20M 100-000 ML, Monochrome, 960x540, uses bayonet style lens	\$1,326.63	
	937710005	P20M 100-000 ML, Monochrome, 960x540, uses C-mount lens	\$1,422.83	
	937710007	P22M 700-000 ML, Monochrome, 1920x1080, uses C-mount lens	\$2,511.64	
	937710006	P20C 000-000 ML, Color, 950x540, uses C-mount lens	\$1,492.31	
	937710008	P22C 600-000 ML, Color, 1920x1080, uses C-mount lens	\$2,594.57	
	95A900010	Bayonet style lens, LNP 601-040 Micro Lens, 6mm Focal Length FF4 1/3", for P2x	\$341.80	
	95A900011	Bayonet style lens, LNP 603-040 Micro Lens, 8mm Focal Length FF4 1/3", for P2x	\$341.80	
	95A900012	Bayonet style lens, LNP 606-040 Micro Lens, 12.5mm Focal Length FF4 1/3", P2x	\$341.80	
	95A900013	Bayonet style lens, LNP 608-040 Micro Lens, 17.5mm Focal Length FF4 1/3", P2x	\$341.80	
	95A900014	LNP Micro Lens Kit M320/P2	\$1,367.01	
	95A900015	Filter RED Bandpass 635nm LT 14L M320/P2, for 14LED lights	\$170.85	
	95A900019	Filter RED Bandpass 625nm LT 36L M320/P2, for 36LED lights	\$227.81	
	MX MACHINE VISION CONTROLLER	959918113	MX-E90-8-B-2, 8 GIG-E, PNP/NPN, WIN10	\$6,850.00
		93ACC0236	DONGLE, IMPACT, ENHANCED	\$842.86
		959933024	CAMERA, E151, GIG-E, 1280X1024, 75FPS, MONO	\$869.31
959933025		CAMERA, E151C, GIG-E, 1280X1024, 75FPS, COLOR	\$918.34	
959933026		CAMERA, E181, GIG-E, 1920X1200, 48FPS, MONO	\$1,250.07	
959933027		CAMERA, E181C, GIG-E, 1920X1200, 48FPS, COLOR	\$1,291.71	
601-0384		CAMERA, M180C, GIG-E, 1628x1236, 20FPS, COLOR **ONLY 3 LEFT**	\$750.00	
959933044		CAMERA, E198, GIG-E, 2448x2048, 20FPS, MONO	\$2,230.64	
959933045		CAMERA, E198C, GIG-E, 2448x2048, 20FPS, COLOR	\$2,292.09	
959982212		CAMERA, 3P, GIG-E, 4096 x 3000, Mono, 8fps	\$3,146.33	

* Prices and stock are subject to change at any time.

	Part Number	Model Number	Description	Price Each
S8	950801180	S8-PR-3-B01-PP	Polarized Retroreflective, PNP	\$42.43
	950801250	S8-PR-3-C01-PP	LED Diffuse, PNP	\$42.43
	950801220	S8-PR-3-M01-PP	LED Background Suppression, PNP	\$63.80
	950801100	S8-PH-3-M01-PP	Laser Background Suppression, PNP	\$110.36
S5N	952001041	S5N-PR-5-B01-PP	Radial, Polarized Retroreflective, PNP	\$21.77
	952001021	S5N-PA-5-B01-PP	Axial, Polarized Retroreflective, PNP	\$21.77
S65	956251161	S65-PA-5-M13-OO	Time of Flight, LED IR, BS. PNP/NPN, LO/DO	\$115.84
SENSOR MOUNTING	95ACC1470	ST-5072	S8 Right Angle Vertical Mount	\$11.94
	95ACC7860	ST-S8-FRM	S8 Right Angle Horizontal Mount	\$10.56
	ST 12-C	ST 12-C	M12 Right Angle Mount	\$2.64
	ST 18-C	ST 18-C	M18 Right Angle Mount	\$2.64
FIELD WIRE	CL12/OB-00A	CL12/OB-00A	Female M12 Field Wireable	\$16.69
	CL08/OA-00A	CL08/OA-00A	Female M8 Field Wireable	\$20.31
M8 CABLES	CD08/OA-050A5	CD08/OA-050A5	M8 Cable, Straight, PUR, Single Ended	\$11.79
	CD08/OA-050C5	CD08/OA-050C5	M8 Cable, Right Angle, PUR, Single Ended	\$11.79
M8 PROX	AE6/AP-3F	AE6/AP-3F	Shielded, NO, PNP	\$16.29
	AE6/AN-3F	AE6/AN-3F	Shielded, NO, NPN	\$16.29
	AE6/AP-2F	AE6/AP-2F	Unshielded, NO, PNP	\$16.29
	AE6/AN-2F	AE6/AN-2F	Unshielded, NO, NPN	\$16.29
M12 PROX	AM6/AP-3H	AM6/AP-3H	Shielded, NO, PNP	\$15.20
	AM6/AN-3H	AM6/AN-3H	Shielded, NO, NPN	\$15.20
	AM6/AP-4H	AM6/AP4H	Unshielded, NO, PNP	\$15.20
	AM6/AN-4H	AM6/AN4H	Unshielded, NO, NPN	\$15.20
M18 PROX	AK6/AP-3H	AK6/AP-3H	Shielded, NO, PNP	\$17.10
	AK6/AP-4H	AK6/AP-4H	Unshielded, NO, PNP	\$17.10
REFLECTORS	95A151340	R4	47 x 47 mm Square Reflector	\$11.79
	S940700075	R5	∅ 75 mm Circular Reflector	\$11.79
	S940700048	R2	∅ 48 mm Hexagonal Reflector	\$11.21
	S940000900	RT-3970	200 x 3000 mm Self-Adhesive Reflective Tape	\$11.21

* Prices and stock are subject to change at any time.

	Part Number	Model Number	Description	Price Each
SAFETY SCANNER	SLS-M5-1708-E	958001030	Master 5.5m, 70 Zone Sets	\$2,428.57
	SLS-SA3-08	958001080	Standalone 3m, 6 Zone Sets	\$1,714.29
	SLS-SA5-08	958001090	Standalone 5.5m, 6 Zone Sets	\$1,928.57
	SLS-R5-E	958001120	Slave 5.5m	\$1,723.03
SLS MOUNT	95ASE2920	SLS-BRACKET-A	SLS Complete Bracket	\$97.44
	95ASE2940	SLS-BRACKET-C	SLS Head Protection Bracket	\$21.80
M12 CABLES	CD12M/OB-050A5	CD12M/OB-050A5	M12 Cable, Straight, PUR, Single Ended	\$11.21
	CD12M/OB-050C5	CD12M/OB-050C5	M12 Cable, Right Angle, PUR, Single Ended	\$11.21
	95ASE1150	CS-A1-02-U-15	M12 Cable, Straight, Single Ended	\$15.81
	95A252950	CS-H1-03-B-001	SLIM Cascading, Straight, Double Ended, 0.1M	\$27.00
	95ASE2550	CS-H1-03-B-005	SLIM Cascading, Straight, Double Ended, 0.5M	\$35.51
	CD12M/OH-050A5	CD12M/OH-050A5	M12 Cable, Straight, PUR, Single Ended	\$12.11
	95ASE1200	CS-A1-03-U-15	M12 Cable, Straight, Single Ended	\$20.13
	95ASE1240	CS-A1-06-U10	M12 Cable, Straight, Single Ended	\$24.14
	95ASE1250	CS-A1-06-U-15	M12 Cable, Straight, Single Ended	\$28.74
	95ASE3030	CS-A1-15-U-15	M12 Cable, Straight, Single Ended	\$19.07
SL4 SLIM TYPE 4 LIGHT CURTAIN	957910340	SL4-14-0150-E	150 mm Length, 14 mm Resolution	383.87
	957910030	SL4-14-0300-E	300 mm Length, 14 mm Resolution	\$510.87
	957910080	SL4-14-0450-E	450 mm Length, 14 mm Resolution	\$616.43
	957910130	SL4-14-0600-E	600 mm Length, 14 mm Resolution	\$731.73
	957910180	SL4-14-0750-E	750 mm Length, 14 mm Resolution	\$822.33
	957910230	SL4-14-0900-E	900 mm Length, 14 mm Resolution	\$937.00
	957910340	SL4-24-0150-E	150 mm Length, 24 mm Resolution	\$385.41
	957910370	SL4-24-0300-E	300 mm Length, 24 mm Resolution	\$549.51
	957910420	SL4-24-0450-E	450 mm Length, 24 mm Resolution	\$559.01
	957910470	SL4-24-0600-E	600 mm Length, 24 mm Resolution	\$610.76
	957910520	SL4-24-0750-E	600 mm Length, 24 mm Resolution	\$694.49
	957910570	SL4-24-0900-E	900 mm Length, 24 mm Resolution	\$748.93
	957910620	SL4-24-1050-E	1050 mm Length, 24 mm Resolution	\$867.44
	957910670	SL4-24-1200-E	1200 mm Length, 24 mm Resolution	\$902.46

* Prices and stock are subject to change at any time.

	Part Number	Model Number	Description	Price Each
SG4 TYPE 4 SAFETY LIGHT CURTAIN	957901010	SG4-14-030-00-E	300 mm Length, 14 mm Resolution	\$613.66
	957901020	SG4-14-045-00-E	450 mm Length, 14 mm Resolution	\$635.54
	957901030	SG4-14-060-00-E	600 mm Length, 14 mm Resolution	\$664.61
	957901040	SG4-14-075-00-E	750 mm Length, 14 mm Resolution	\$728.89
	957901050	SG4-14-090-00-E	900 mm Length, 14 mm Resolution	\$892.64
	957901060	SG4-14-105-00-E	1050 mm Length, 14 mm Resolution	\$976.96
	957901070	SG4-14-120-00-E	1200 mm Length, 14 mm Resolution	\$1,062.40
	957901090	SG4-14-150-00-E	1500 mm Length, 14 mm Resolution	1312.97
	957901110	SG4-14-180-00-E	1800 mm Length, 14 mm Resolution	\$1,539.37
	957901120	SG4-30-015-00-E	150 mm Length, 30 mm Resolution	\$361.80
	957901130	SG4-30-030-00-E	300 mm Length, 30 mm Resolution	\$424.87
	957901140	SG4-30-045-00-E	450 mm Length, 30 mm Resolution	\$488.79
	957901150	SG4-30-060-00-E	600 mm Length, 30 mm Resolution	\$584.73
	957901160	SG4-30-075-00-E	750 mm Length, 30 mm Resolution	\$678.61
	957901170	SG4-30-090-00-E	900 mm Length, 30 mm Resolution	\$734.60
	957901180	SG4-30-105-00-E	1050 mm Length, 30 mm Resolution	\$782.67
	957901190	SG4-30-120-00-E	1200 mm Length, 30 mm Resolution	\$924.61
	957901210	SG4-30-150-00-E	1500 mm Length, 30 mm Resolution	\$1,017.30
	957901220	SG4-30-165-00-E	1650 mm Length, 30 mm Resolution	\$1,087.31
SAFETY RELAY	95ACC6170	SE-SR2	Safety Relay Relay 3NO + 1NC, DIN-Rail 23 mm	\$143.27
	605-000-728	YRB-4EML-31S	Contrinex Safety Relay, 3 NO and 1 NC Outputs LED indicator for channels 1, 2 and power supply 22.5 mm wide, DIN-Rail	\$143.27

* Prices and stock are subject to change at any time.